

POUND WOOD
NATURE RESERVE

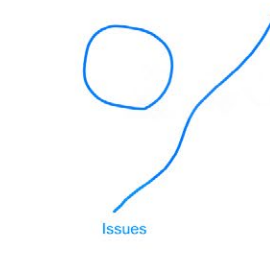



POUND WOOD
NATURE RESERVE



A8. PROPOSED SITE ACCESS ARRANGEMENTS





Location of accesses adjoining from the east onto Daws Heath Road based upon drawing number 211.200.23 supplied by DAP Architecture.

- NOTES:
1. THIS DRAWING IS INDICATIVE AND SUBJECT TO DISCUSSIONS WITH LOCAL & NATIONAL HIGHWAY AUTHORITIES. THIS DESIGN IS ALSO SUBJECT TO CONFIRMATION OF LAND OWNERSHIP, TOPOGRAPHY, LOCATION OF STATUTORY SERVICES, DETAILED DESIGN AND TRAFFIC MODELLING.
 2. THIS DRAWING IS BASED UPON DRAWING NUMBER SURV1826 SUPPLIED BY COUNTRYSIDE PROPERTIES AND ICENI PROJECTS LTD. SHALL NOT BE LIABLE FOR ANY INACCURACIES OR DEFICIENCIES.
 3. HIGHWAY BOUNDARY INFORMATION HAS BEEN PROVIDED BY ESSEX COUNTY COUNCIL ON 14/05/2014 AND HAS BEEN TRANSCRIBED BY ICENI PROJECTS LTD ONTO A TOPOGRAPHICAL SURVEY BASE. ICENI PROJECTS LTD ACCEPTS NO LIABILITY FOR THE ACCURACY OF THE DATA PROVIDED AND THE HIGHWAY BOUNDARY INFORMATION SHOWN IS SUBJECT TO CHECKS BY A LICENSED CONVEYANCER.

KEY:

 EXTENT OF HIGHWAY BOUNDARY

 2.4m X 43m VISIBILITY SPLAY IN ACCORDANCE WITH MANUAL FOR STREETS STANDARDS

 SITE BOUNDARY

C	31.05.2022	AMENDED CLIENT NAME	AP	ME	ME
B	27/05/22	AMENDMENTS FOLLOWING RSA RADII WIDENED, ADDITION OF TACTILE PAVING	MG	ME	ME
A	07/03/17	EXISTING CARRIAGEWAY AMENDMENTS	MG	ME	ME
REV	DATE	AMENDMENTS	DRAWN	CHK	APP

ICENI PROJECTS LIMITED
DA VINCI HOUSE
44 SAFFRON HILL
LONDON
EC1N 8FH

T 020 3640 8508
mail@iceniprojects.com



CLIENT

COUNTRYSIDE PARTNERSHIPS

PROJECT

DAWS HEATH ROAD

TITLE

PROPOSED PRIORITY JUNCTION

DRAWN BY	CHECKED BY	RA	APPROVED BY	ME
TG	21/02/2017		21/02/2017	
SCALE @ A3	1:250	DATE	21/02/2107	
PROJECT NO.	16-T022	DRAWING NO.	09	REV. C

iceni Projects accept no responsibility for any unauthorised amendments to this drawing. Only figured dimensions are to be worked to.

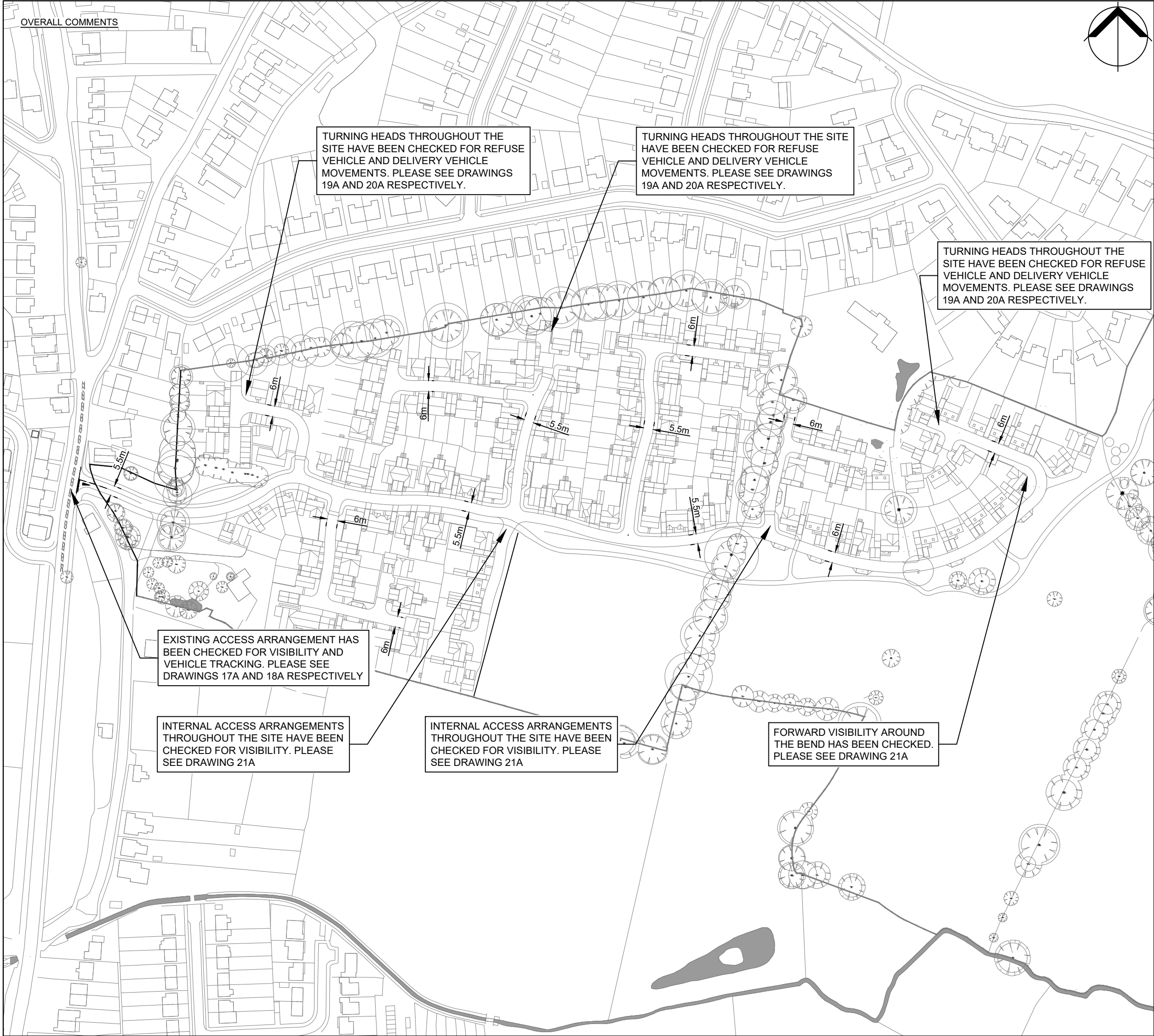

OVERALL COMMENTS

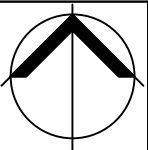

NOTES:
1. THIS DRAWING IS INDICATIVE AND SUBJECT TO DISCUSSIONS WITH LOCAL & NATIONAL HIGHWAY AUTHORITIES. THIS DESIGN IS ALSO SUBJECT TO CONFIRMATION OF LAND OWNERSHIP, TOPOGRAPHY, LOCATION OF STATUTORY SERVICES, DETAILED DESIGN AND TRAFFIC MODELLING.
2. THIS DRAWING IS BASED UPON DRAWING NUMBER SCHEME DAPA_1762_300_03_SCHEME LAYOUT SUPPLIED BY DAP ARCHITECTS AND ICENI PROJECTS LTD. SHALL NOT BE LIABLE FOR ANY INACCURACIES OR DEFICIENCIES.

B	31.05.2022	AMENDED CLIENT NAME	AP	ME	ME
A	20.05.2022	ECC COMMENTS ADDED	MZ	MG	ME
REV	DATE	AMENDMENTS	DRAWN	CHK	APP

ICENI PROJECTS LIMITED
DA VINCI HOUSE
44 SAFFRON HILL
LONDON
EC1N 8FH

T 020 3640 8508
mail@iceniprojects.com



CLIENT

COUNTRYSIDE PARTNERSHIPS

PROJECT

DAWS HEATH ROAD

TITLE

SITE LAYOUT REVIEW

(OVERALL COMMENTS)

DRAWN BY	CHECKED BY	APPROVED BY
AP	ME	ME
	30.03.2022	30.03.2022

SCALE @ A3	DATE
1 : 2,000	30.03.2022

PROJECT NO.	DRAWING NO.	REV.
16-T022	16	B

iceni Projects accept no responsibility for any unauthorised amendments to this drawing. Only figured dimensions are to be worked to.